

Inductive Static Contactor User Manual



**ADDRESS: Ikitelli OSB Mah. Cevre 14.
Blok Sok. Telas Blok Dis Kapi No: 1
Kat: 1-2 Basaksehir/Istanbul**

**Phone: +90 212 438 80 24
Fax: +90 212 438 80 25**

info@gruparge.com

PROPER USE AND SAFETY REQUIREMENTS



Cut all the power when connecting and disconnecting the device to a panel.



Do not clean the device with a solvent or similar material. Only use a dry cloth.



Please do not intervene to the device when a technical problem is encountered and get in contact with a technical service within the shortest time.



If the warnings are not taken into account, our company or the authorized dealer shall not be held responsible for the negative consequences.



Do not dispose in the trash, the device must be delivered to the collection centers (electronic device recycling centers). It should be recycled or disposed of without harming human health and environment.



The installation, assembly, activation and operation of the device should be done and used by only expert professionals and in accordance with safety regulations and instructions.

CONTENTS

PROPER USE AND SAFETY REQUIREMENTS	3
1.INTRODUCTION.....	4
1.1. General Features	4
1.2. Technical Features	4
1.3. Technical Drawing	4
1.3.1. ESK 10 Technical Drawing	4
1.3.2. ESK 20 Technical Drawing	4
1.3.3. ESK 30 Technical Drawing	5
1.3.4. ESK 50 Technical Drawing	5
1.4. Connection Diagram	5
1.4.1. ESK (10) - Single Phase Shunt Reactor	5
1.4.2. ESK (10) - Three Phase Shunt Reactor	6
1.4.3. ESK (20-30-50) - Single Phase Shunt Reactor	6
1.4.4. ESK (20-30-50) - Three Phase Shunt Reactor	6

1. INTRODUCTION

1.1. General Features

Inductive Static Contactors are designed to be used for switching three-phase shunt reactors connected to steps. They have advantages over contactors such as silent operation, long life and low failure rates.

1.2. Technical Features

Product Code	Product Name	Product Description	Voltage (V)	Nominal Cable Section (mm ²)	Nominal Fuse Current (A)	Cooling		Assembly Direction Led	Input, Output and Triggering Control LEDs	Internal Thermal Protection	External Thermal Protection	Dimensions W x L x D (mm)
						Fan	Fanless Natural					
GA2221	ESK 10T3	10 kVAr END. STATIC CON.	230/400	3(1x2,5)	25		✓	✓	✓	✓	✓	167 x 130 x 131
GA2222	ESK 20T3	20 kVAr END. STATIC CON.	230/400	3(1x6)	50		✓	✓	✓	✓	✓	167 x 160 x 131
GA2223	ESK 30T3	30 kVAr END. STATIC CON.	230/400	3(1x10)	80		✓	✓	✓	✓	✓	167 x 160 x 131
GA2224	ESK 50T3	50 kVAr END. STATIC CON.	230/400	3(1x25)	125	✓		✓	✓	✓	✓	167 x 210 x 141

- All models have 3 thyristors and are suitable for three-phase use.
- NC (normally closed) thermal control is available for ESK20-30-50.

1.3. Technical Drawing

1.3.1. Inductive Static Contactors ESK 10



1.3.2. Inductive Static Contactors ESK 20

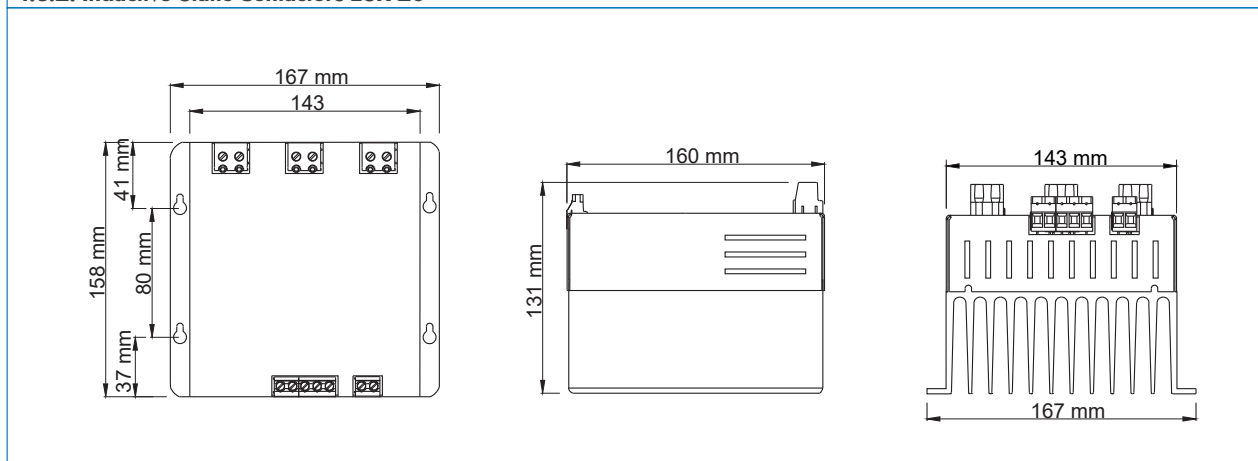

1.3.3. Inductive Static Contactors ESK 30

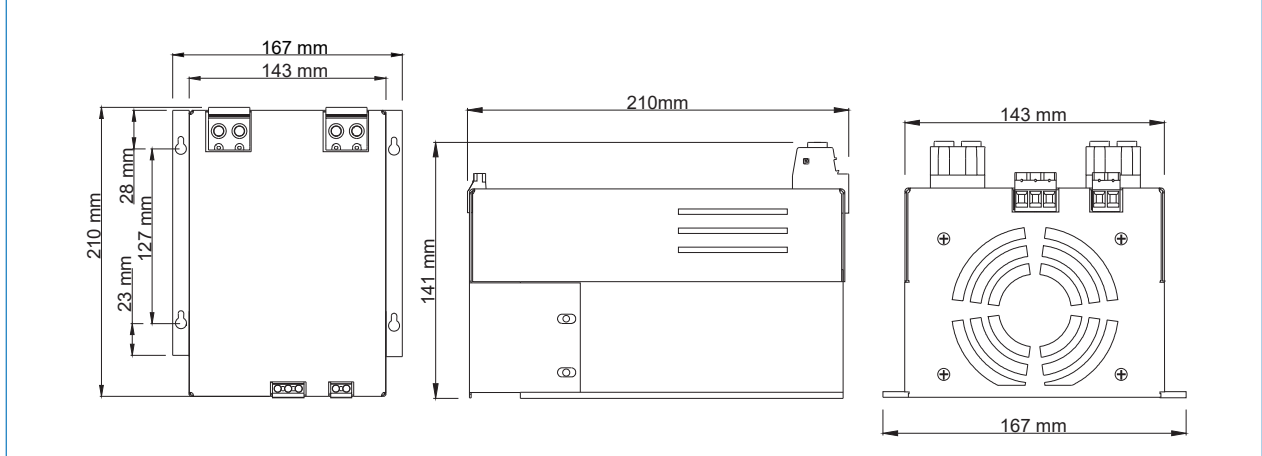

1.3.4. Inductive Static Contactors ESK 50

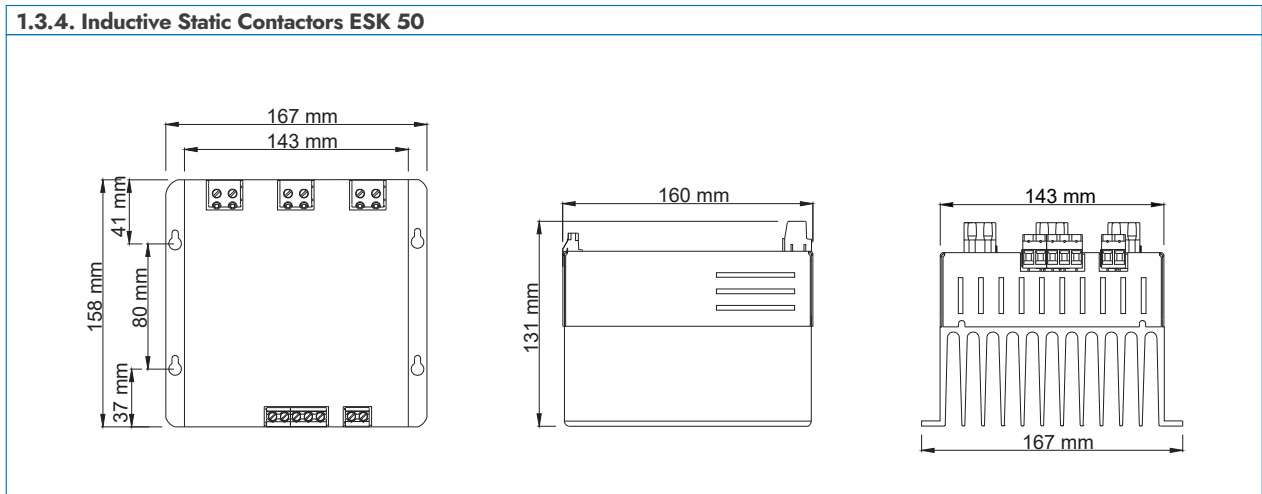

1.4. Connection Diagram

1.4.1. ESK (10) - Single Phase Shunt Reactor

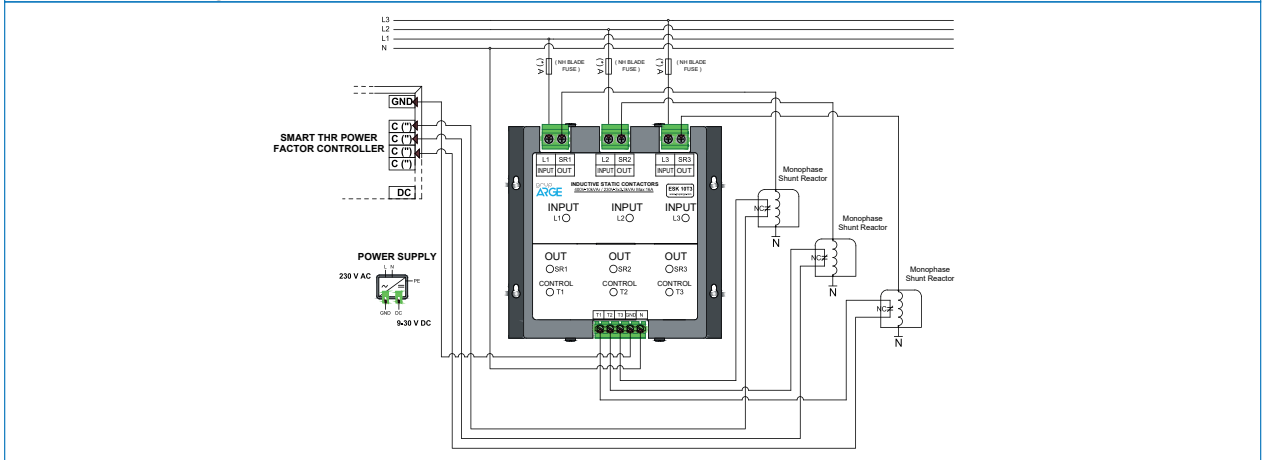

1.4.2. ESK (10) - Three Phase Shunt Reactor

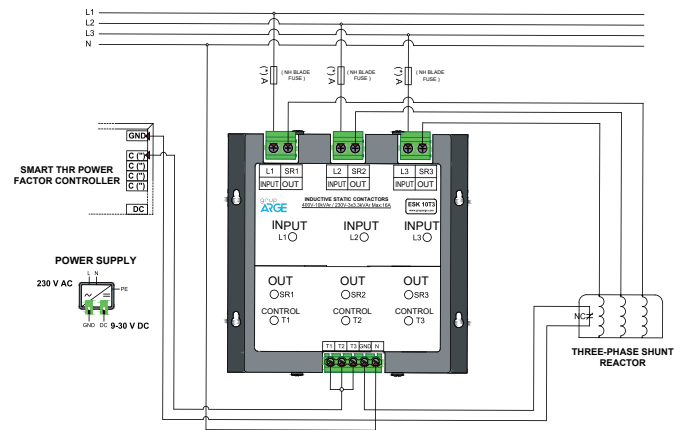

1.4.3. ESK (20-30-50) - Single Phase Shunt Reactor

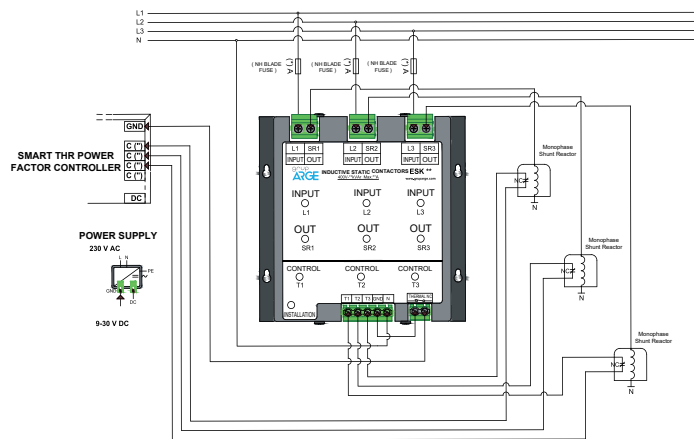

1.4.4. ESK (20-30-50) - Three Phase Shunt Reactor

